

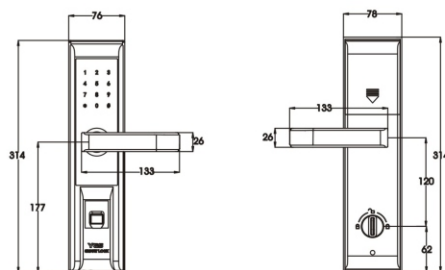

YGS8861FMC Residential lock series

Digital door lock with 4 access ways and 993 super big user capacity, ideal to replace old mechanical lock with modernized solution. This is also the best quality/price ratio model for apartment projects.



FEATURES

Material	Zinc Alloy, Acrylic
Mortise	Center Distance:68mm;Backset:60mm
Applied Door Thickness	35~110mm
Power	6V(Alkaline AA battery x4)
Battery Life Time	5000~6000 times
Emergency Power	Micro-USB
Operating Temperature	-15~55°C
Fingerprint Sensor	Optical Sensor
Password	6 Digits
Mechanical key	3 keys

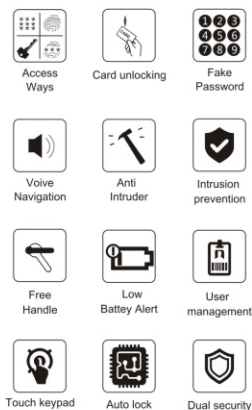

Manual knob to extend and retract the secure deadbolt. It increases the security level of the door lock with double lock extend.



C grade cylinder protects the lock from technical unlocking for at least 270mins.



MORTISE

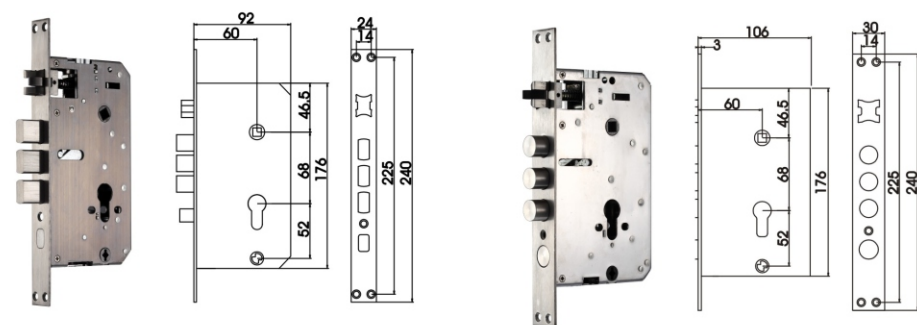

(Unit:mm)

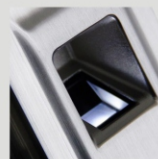

Optical fingerprint scanner, 0.3sec collection rate and less than 0.01% recognition fault.

It works stably in aggressive environments.(-15~60°C , 20%-95% humidity)



If the battery power is running low, an automatic alert is activated via a red light that is displayed when unlock.

This signal is given months before the battery needs to be replaced.