

Tuya App Door Lock

Operation Manual



Wifi Module Introduction:





- ◆ Power consumption: <math><20\mu\text{A}</math> (sleep power consumption), about 50mA (working power consumption);
- ◆ Temporary authorization: support dynamic password and temporary password validity authorization;
- ◆ Message reporting: No gateway required, directly connect to a router, and local unlocking events of door locks are reported to the cloud in real time;
- ◆ Support APP: Support Tuya Smart APP;

1. Add administrator







① Before connect the door lock ,it must be add the admin. Light up the door lock screen, click [*]+[#] on the touchpad to input new administrator.

Add Admin User

There are 9 groups of admin information (fingerprint / password / card).

| | |
|--|--|
| SET  | Press "SET", enter admin information. |
|     | Input 6 digit password + "#", or input fingerprint 3 times, or read card. After adding 1 Admin, press 4 to continue adding other Admin. |

Add Normal User

| | |
|---|---|
| SET  | Press "SET", enter admin information. |
|    | Press 1 to add user. Input 6 digit password + "#", or input fingerprint 3 times, or read card. |
|    | Mark down the User ID and user information for easy delete in the future. |

2. Registration and login

2.1 APP download

Please download Tuya via App Store or Google play or scan the QR code.

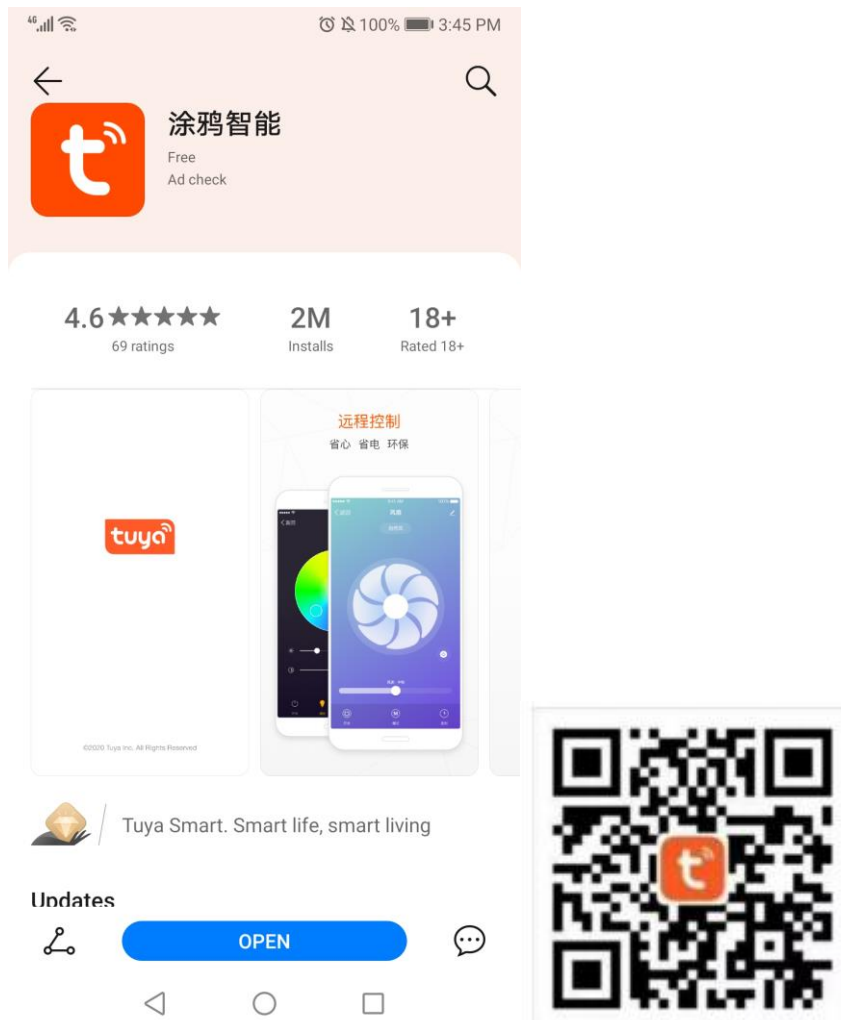

2.2 Login authentication

- ① Login by email or phone number
- ② Edit user information

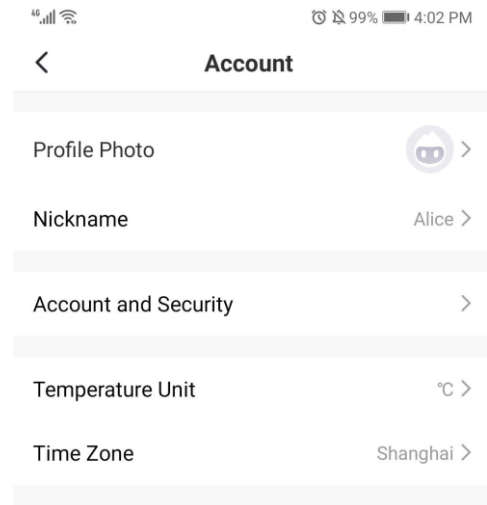
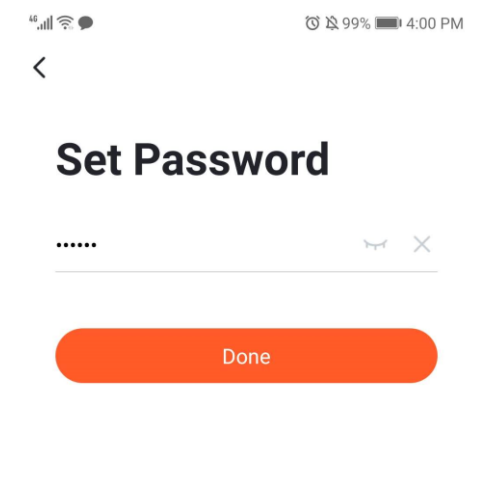
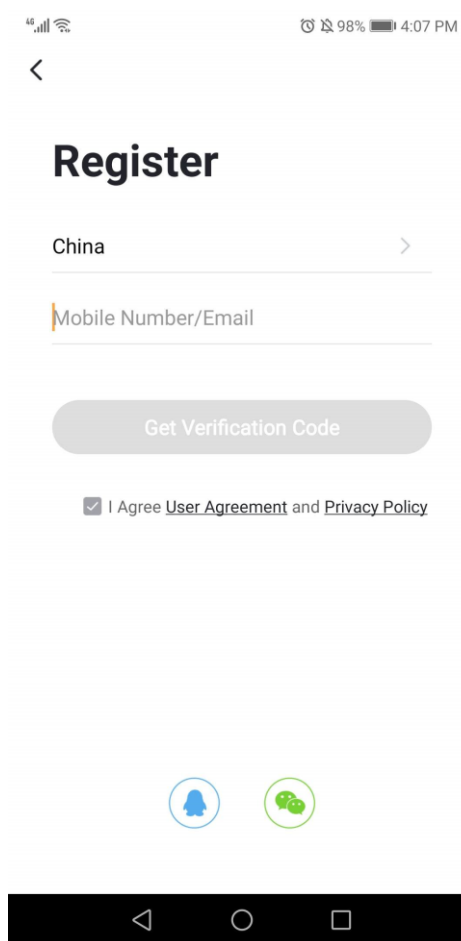
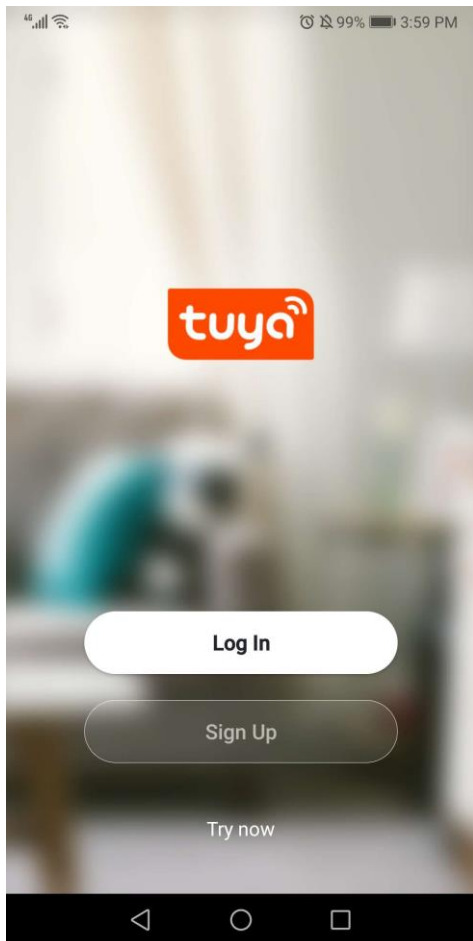

3. Lock management

3.1 Lock adding

① Open Bluetooth

② Make sure that the door lock has added an administrator user before adding Tuya WIFI door lock

③ After you are ready to add a device, click "Add Device" or "+" on the upper right of the APP homepage, and enter "Add Equipment" page;

④ Click "Security Sensing" and find "Door Lock (Wi-Fi)" to enter;

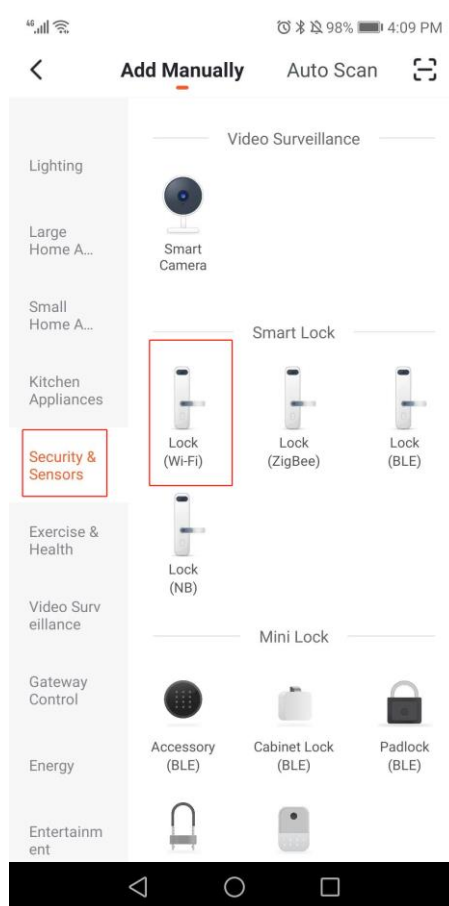
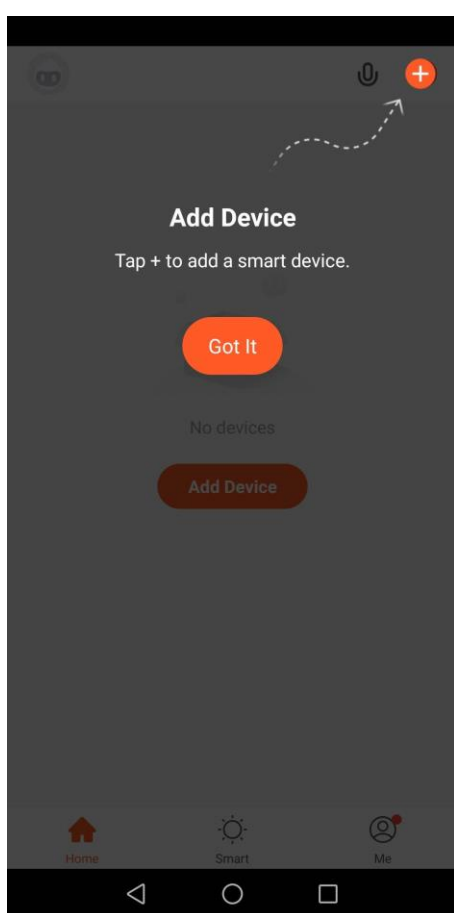

⑤. Select 2.4GHz Wi-Fi network and enter the password to enter the next step. If GPS positioning is not turned on, turn on this.

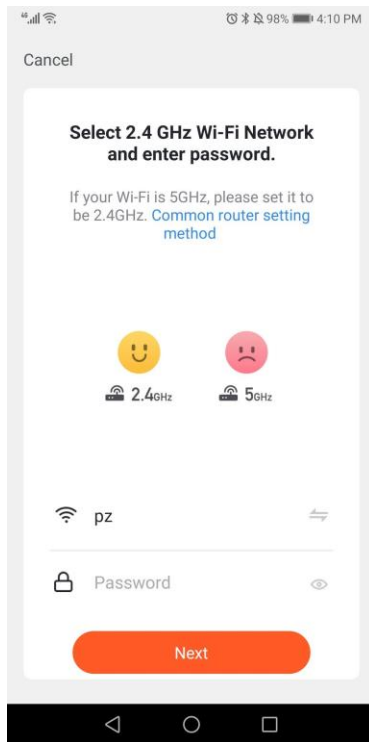

⑥ Short press “set” key, wait for the Wi-Fi module indicator to flash quickly, then enter the network distribution mode;



⑦ Select fast flashing (0.5/1 time) on the App for pairing;

Wait for the successful addition, modify the [device name], and click [Finish].

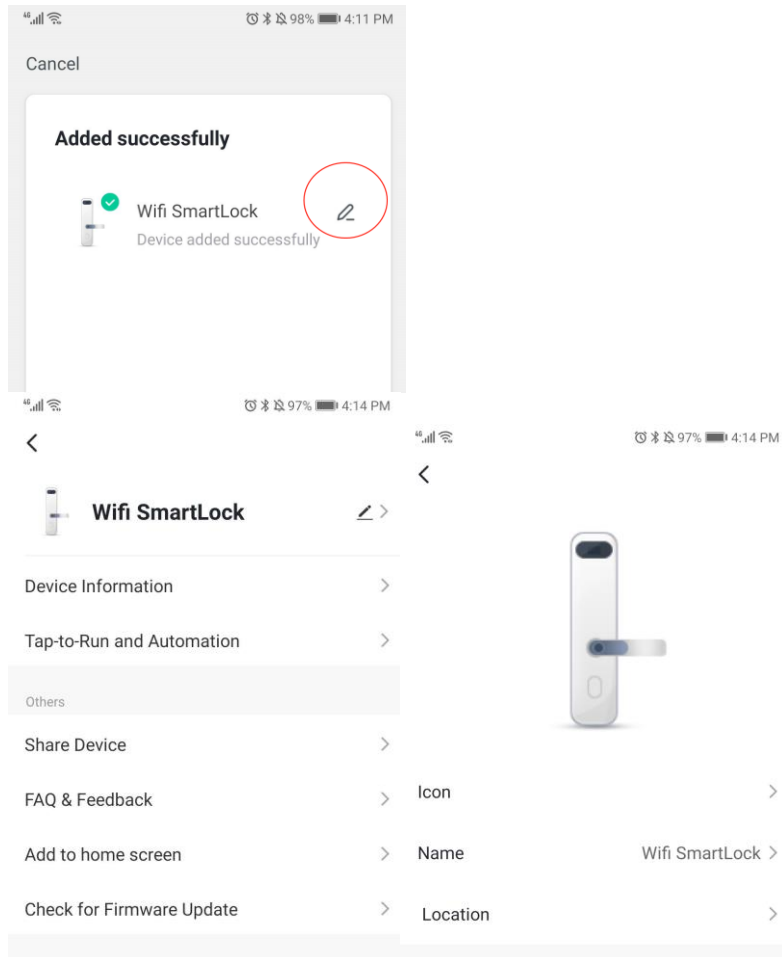

4. WiFi smart door lock APP application

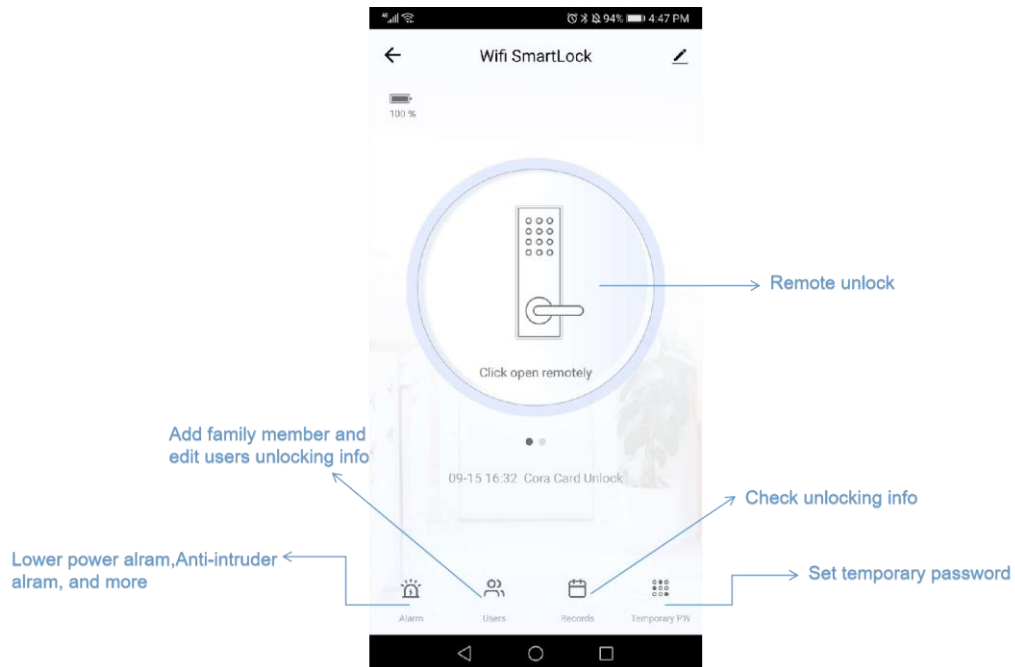

5. Member management:

①Click "users" and click "+" on the upper right of the APP homepage and choose "family" and add.

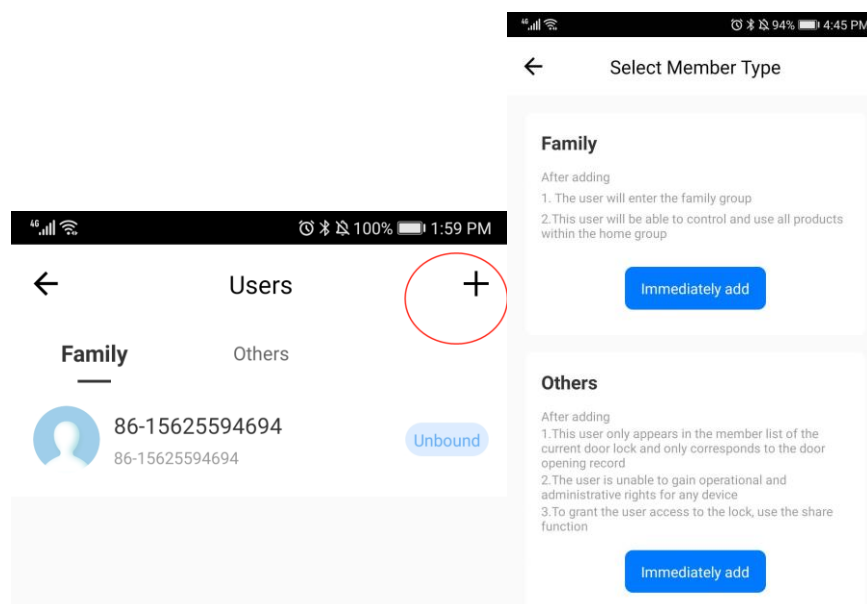

② Input the family members info, and the family members would receive an invitation message.

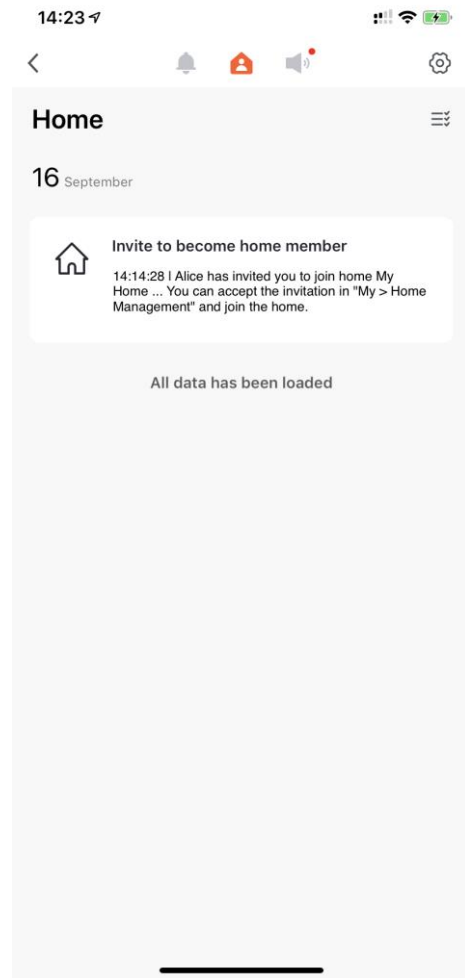
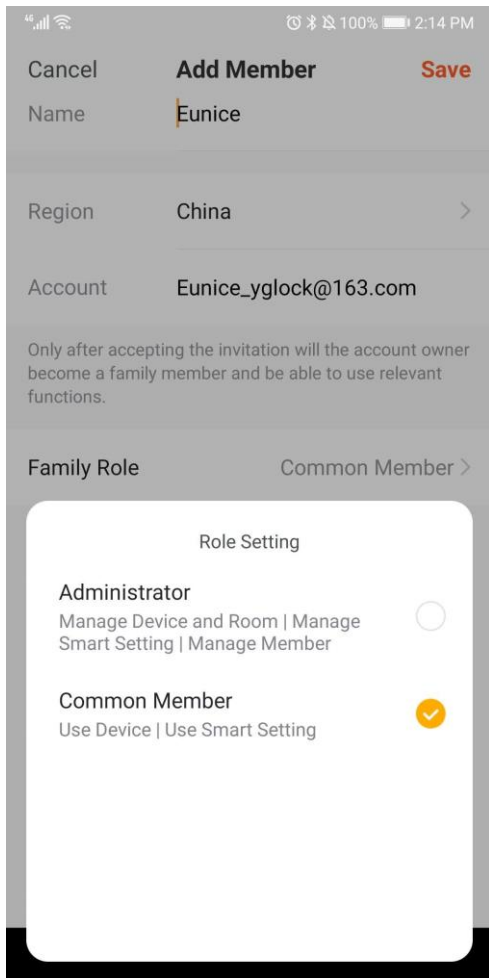

③ Choose one member to edit and input the access info:

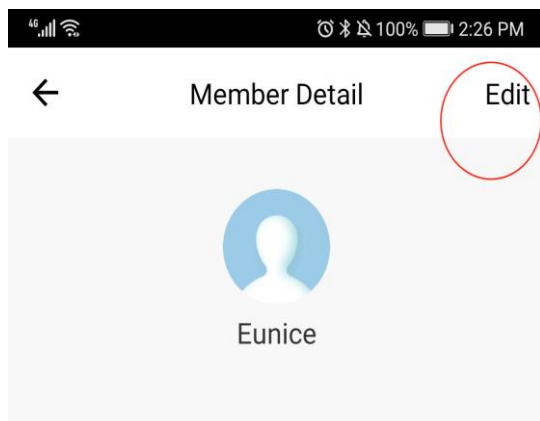
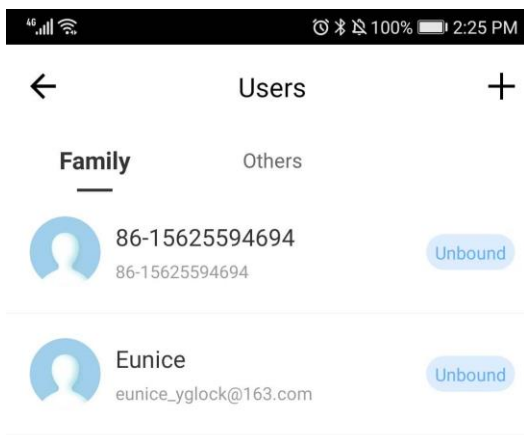

④It requests to input the unlock number when add the fingerprint, password and card, it needs to operate “add users” on the lock first and remember the users number and then input the number. Operation can check Page 2.

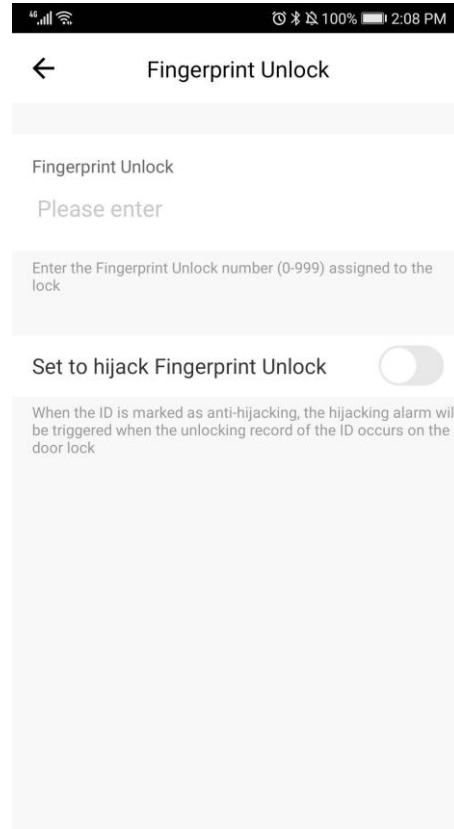
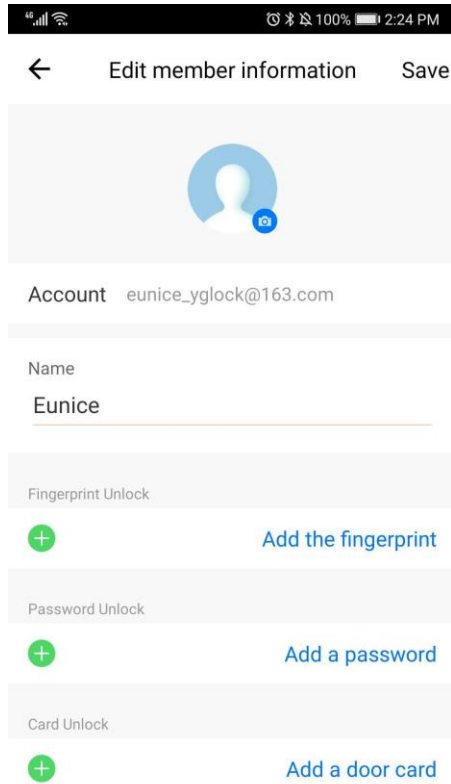

If click “Others” to add, same operation as 5.④

6. Temporary password

① Create a temporary password on the APP, enter the password, name and valid time, after creation, it will display "to be issued";

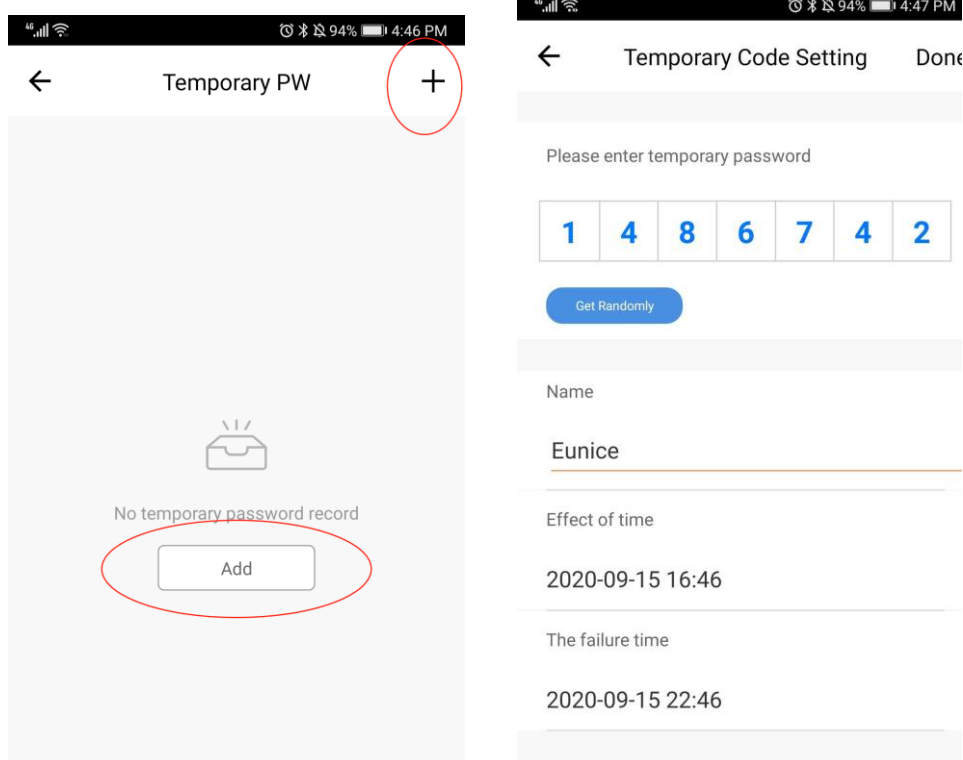

② Press "9" + "#" on the door lock to wake up the Tuya module, and the module indicator will light up.

Waiting for the connection, the temporary password of the cloud will be obtained after the connection, and the status of the temporary password will be changed from "syncing" to "valid".

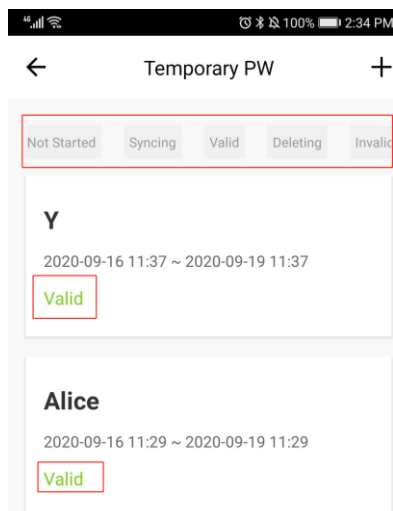

7. Remote unlock function

① Press "9" + "#" on the door lock to wake up the Tuya module, and the module indicator will light up.

② Wait for the module to connect to the cloud. On the home page of the APP interface, a button of "click open remotely" will appear. Confirm whether to unlock;

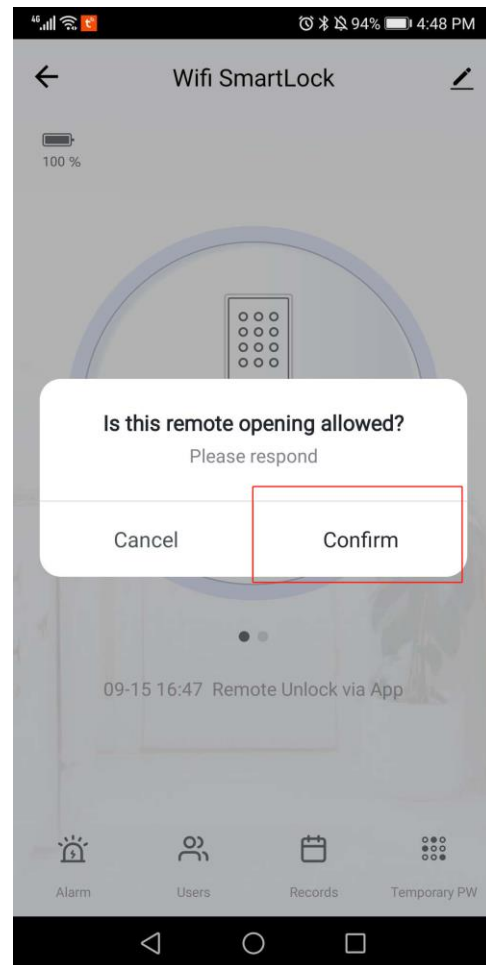
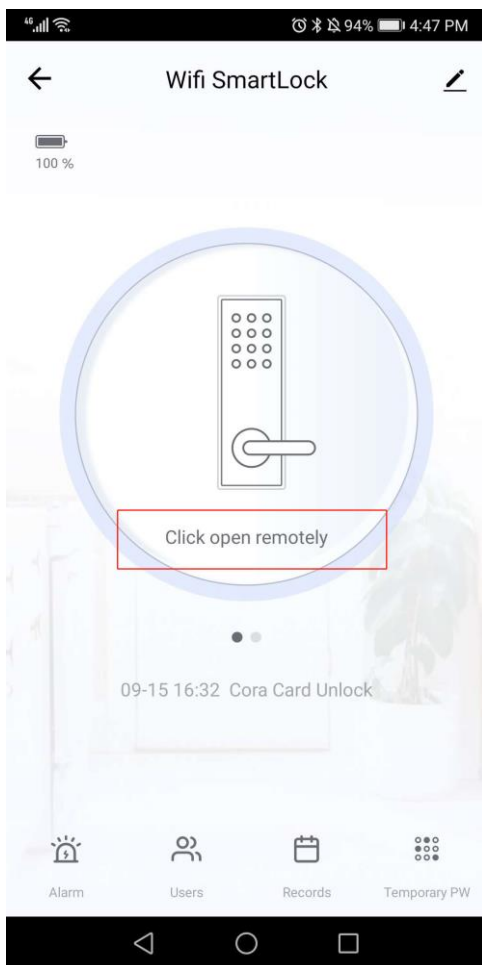

8. Remote dynamic password

① Click "click on the get" under the remote dynamic password on the APP side to get the password;

② Press "9" + "#" at the door lock to wake up the Tuya module, and the module indicator will light up.

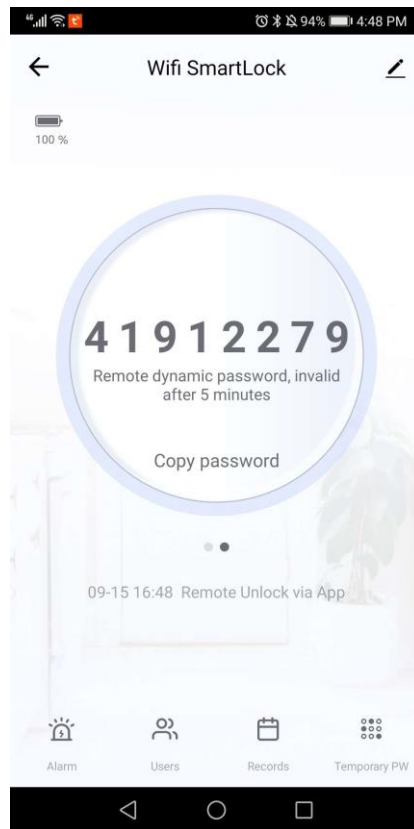
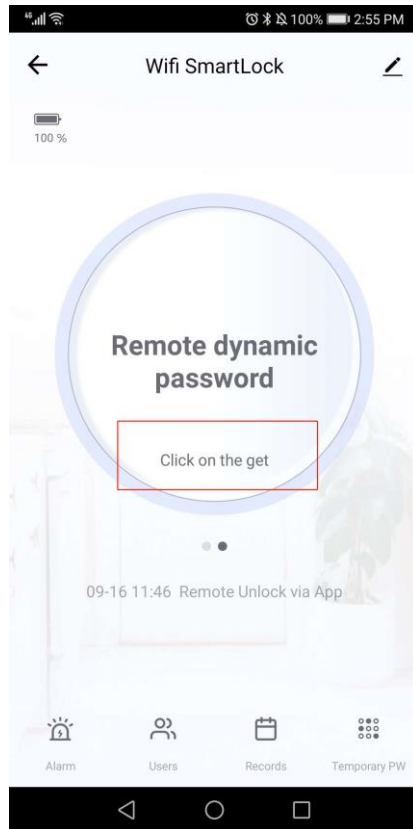

9. Lock initialization

Long press the [SET] button on the back panel until lock sounds beep.

Then all lock information will be removed.

