

DIGITAL DOOR LOCK

Operation Instruction

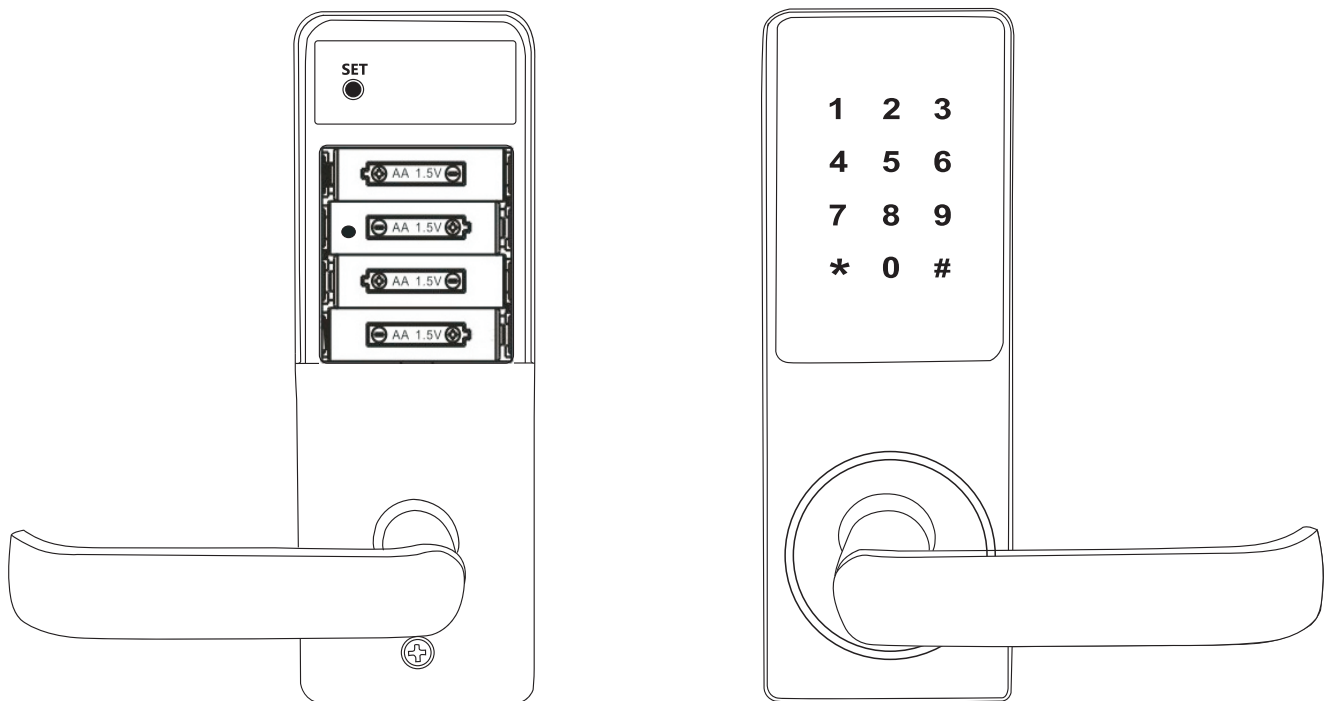

Product Guide

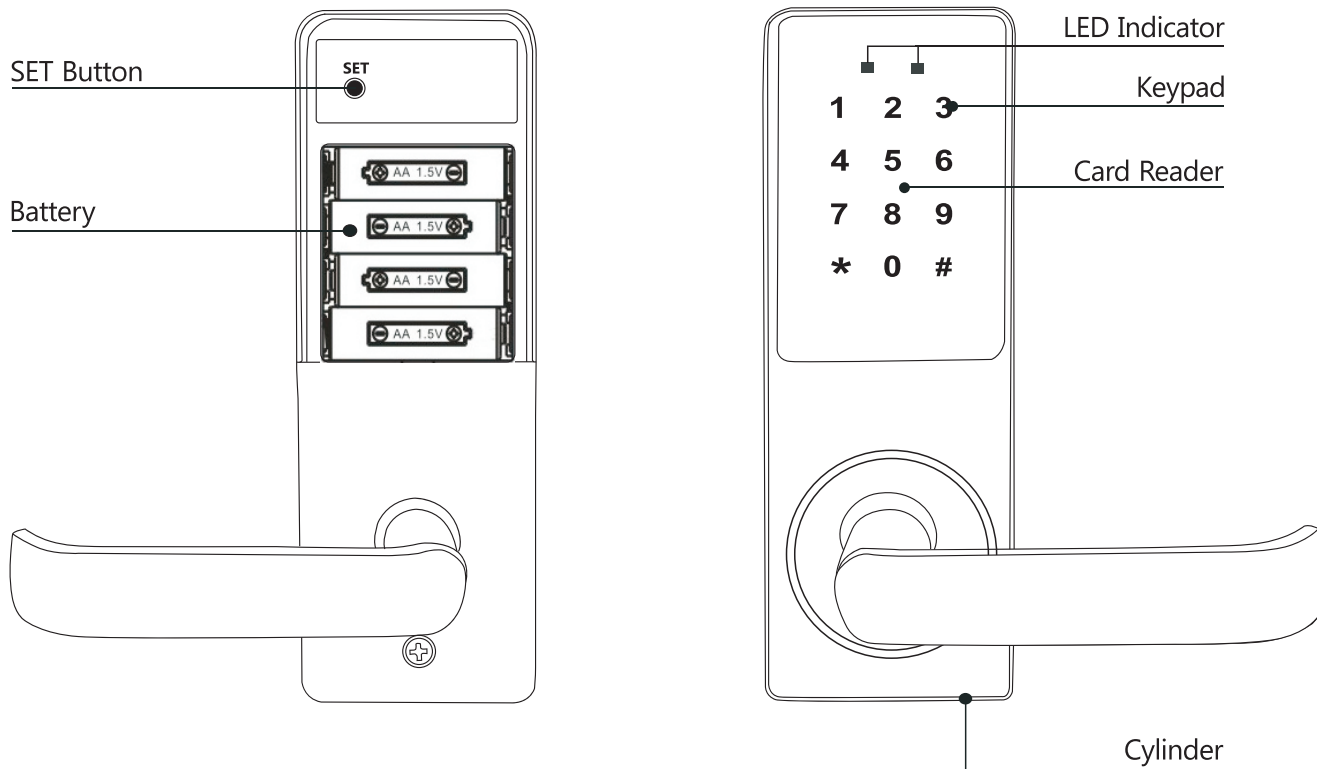

Brief Introduction

- 1 There are 30 password users and 100 RF card users in the lock.
- 2 The password has to be 4 to 6 digits combination among 0 to 9;

Operation

1 Password Unlocking

Touch the keypad to activate the lock, and then input the password with press “#” to finish. If the password is correct, the LED indicator shows blue light with sounds, and then you can press down the handle for unlocking.

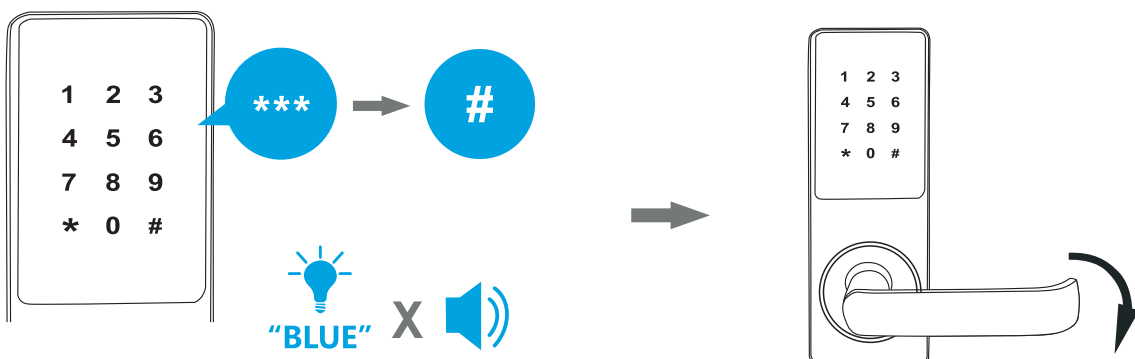

If you input a wrong password for 5 times, the lock will be locked for 3 minutes. During the 3 minutes, the lock cannot be activated and all operations are not available. After that, the lock returns to normal state.

Random Password Protection:

For a better security protection to the password user, the lock is designed with a random password protection. You can add any digits before and after the real password.

For example, the password is “123-456”, you can unlock the lock by inputting the password as following:

1:

2:

3:

RF Card Unlocking

Place the card close to keypad. If the card is correct, the LED indicator shows blue light with sounds, and then you can press down the handle for unlocking.



Mechanical Key Unlocking

When there are problems with electronic part, and the batteries run out of power using mechanical key is the way to unlock the lock.

Insert the mechanical key into the cylinder under the bottom of outside panel, and then turn the key 90 degree. After that, press down the handle for unlocking.

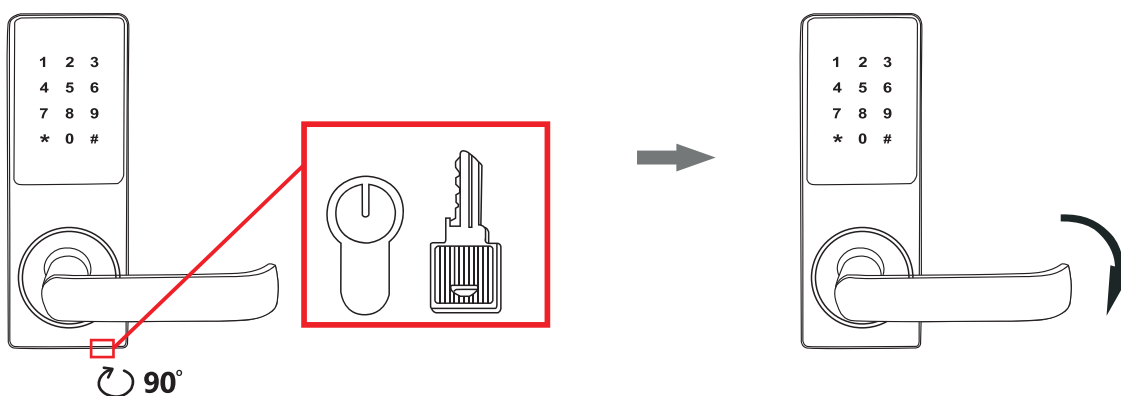

The mechanical key cannot unlock the lock directly.

2 Change Admin Password

The default admin password is "123-456" when the lock is under factory state. It is suggested to change the admin password before use.

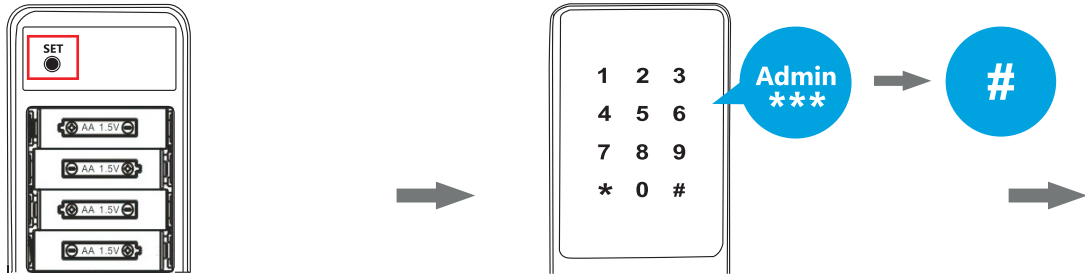

a Take out the battery case cover, and then press the "Set" button on the battery case;

b Input the admin password "123-456", and then press "#" to confirm;

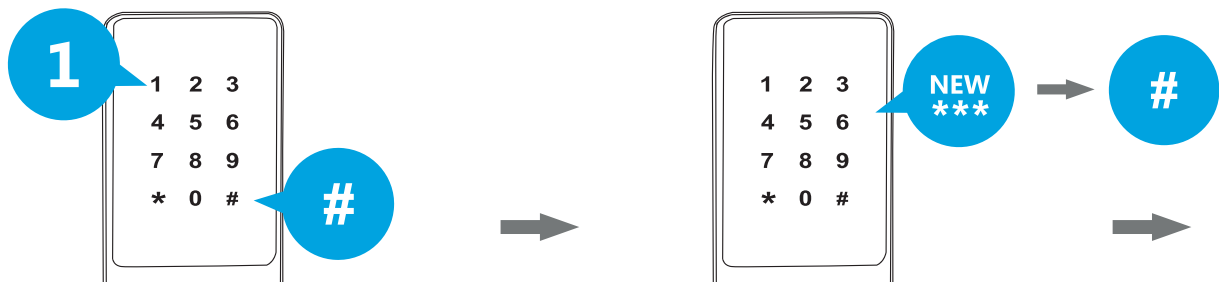

c Input "1", and then press "#" to confirm;

d Input the new admin password (4 to 6 digits), and then press "#" to confirm;

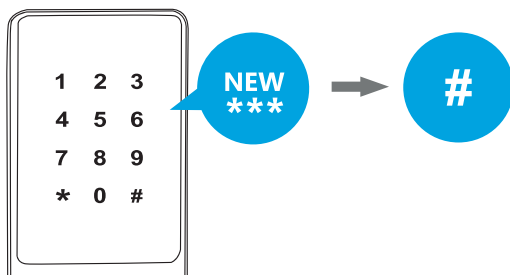

e Input the new admin password (4 to 6 digits) again, and then press "#" to confirm;



Once finishing the operations, please try to use the OLD admin password and the NEW admin password for unlocking to confirm the operation is successful.

3 Add Normal Users (Password User)

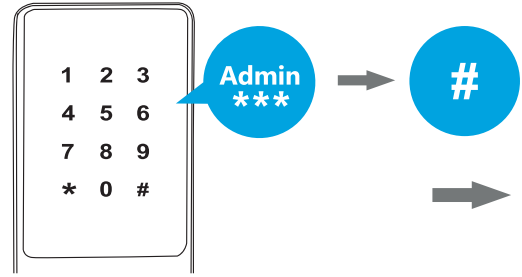
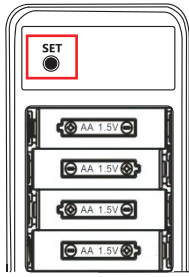

a Take out the battery case cover, and then press "Set" button on the battery case;

b Input the admin password, and then press "#" to confirm;

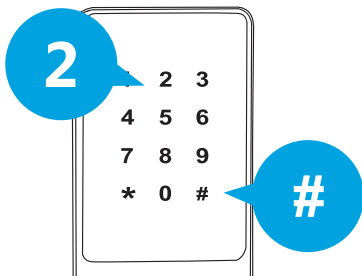

c Input "2", and then press "#" to confirm;

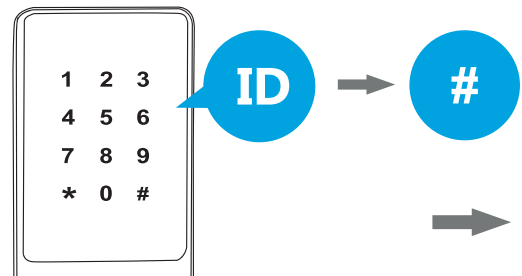

d Input the User number (2 digits, from "01" to "87"), and then press "#" to confirm;

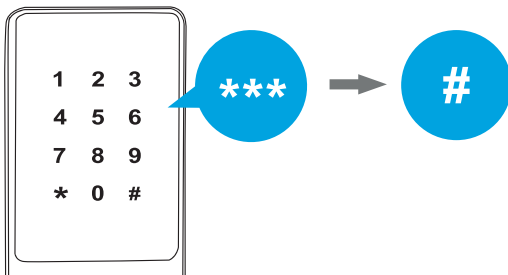

e Input the password (4 to 6 digits), and then press "#" to confirm;

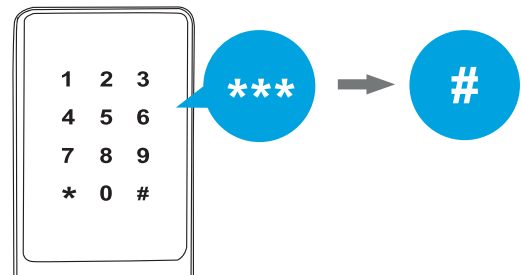

f Input the password (4 to 6 digits) again, then then press "#" to confirm;

 **The password has to be 4 to 6 digits;**

 **Once finishing the operations, please try to use the password for unlocking to confirm the operation is successful.**

 **The user number management is disabled by default. The user number is only requested for registration when the user number management is enable.**

4 Add Normal Users (RF Card User)

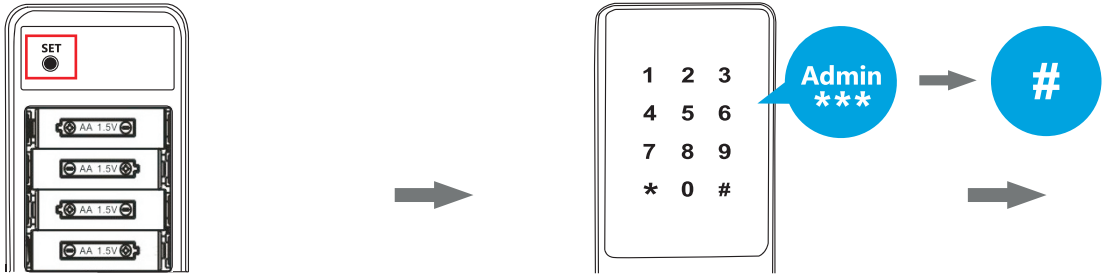

a Take out the battery case cover, and then press "Set" button on the battery case;

b Input the admin password, and then press "#" to confirm;

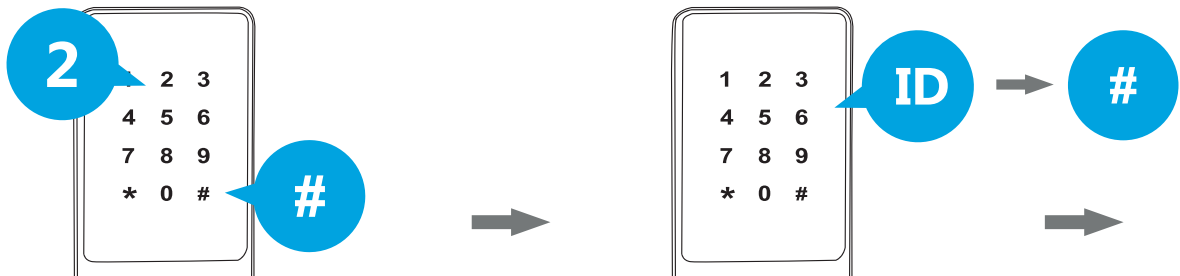

c Input "2", and then press "#" to confirm;

d Input the User number (2 digits, from "01" to "87"), and then press "#" to confirm;

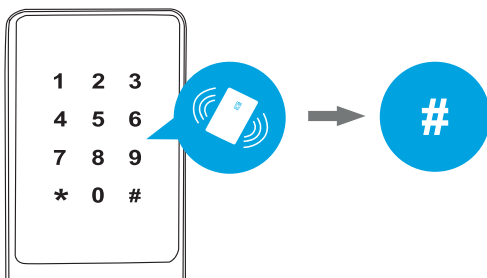

e Place the card close to the card reader, and then finish the registration;

 **Once finishing the operations, please try to use the RF card for unlocking to confirm the operation is successful.**

 **The user number management is disabled by default. The user number is only requested for registration when the user number management is enable.**

5 Delete Single User

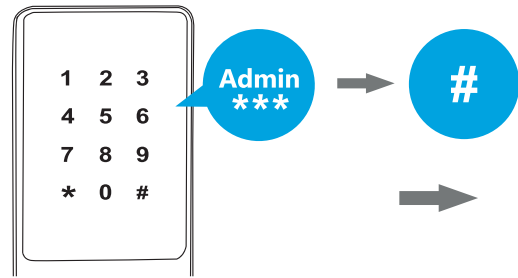
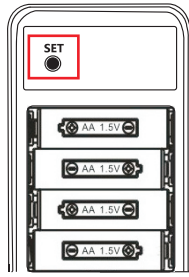

- a Take out the battery case cover, and then press "Set" button on the battery case;

- b Input the admin password, and then press "#" to confirm;

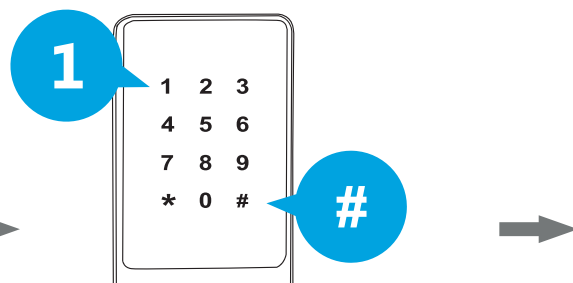
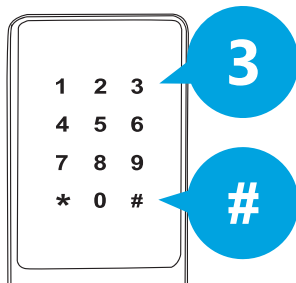

- c Input "3", and then press "#" to confirm;

- d Input "1", and then press "#" to confirm;

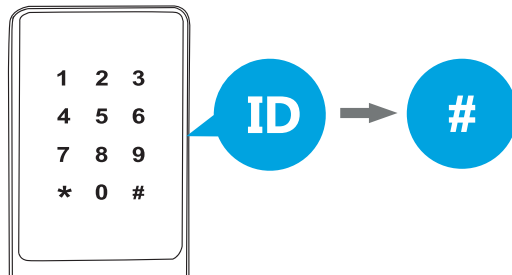

- e Input the User number which you want to delete, and then press "#" to confirm. The system will delete that user;



Once finishing the operations, please try to use that deleted user for unlocking to confirm the operation is successful.

6 Delete All RF Card Users

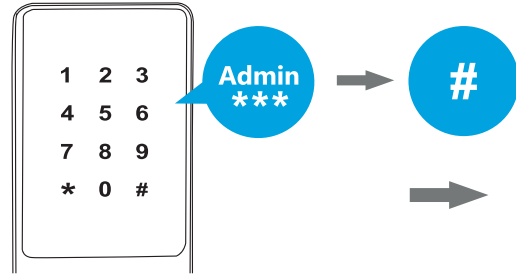
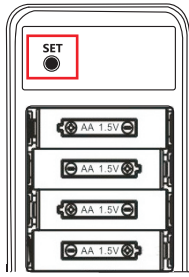

- a Take out the battery case cover, and then press "Set" button on the battery case;

- b Input the Admin password, and then press "#" to confirm;

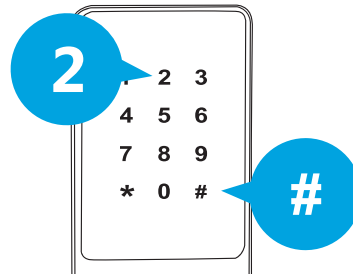
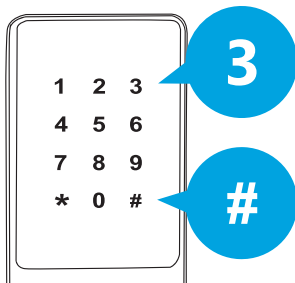

- c Input "3", and then press "#" to confirm;

- d Input "2", and then press "#" to confirm;

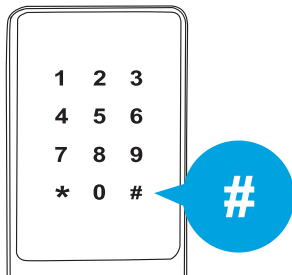

- e Input "#" again to confirm. The system starts to delete all RF card users;



Once finishing the operations, please try to use the deleted user for unlocking to confirm the operation is successful.

7 Delete All Password Users

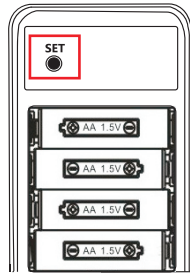

a Take out the battery case cover, and then press "Set" button on the battery case;

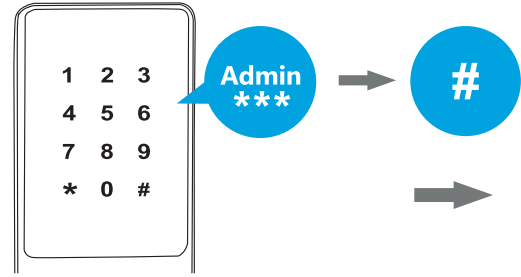

b Input the Admin password, and then press "#" to confirm;

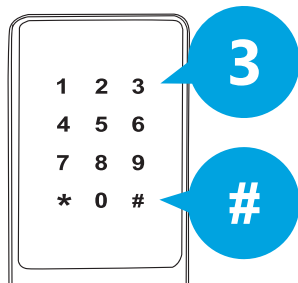

c Input "3", and then press "#" to confirm;

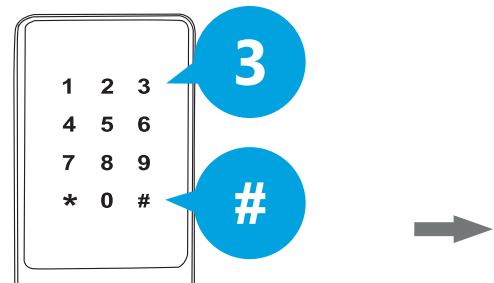

d Input "3", and then press "#" to confirm;

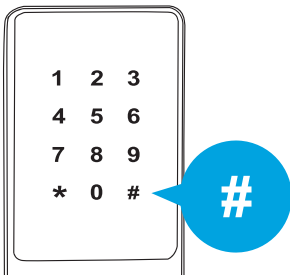

e Input "#" again to confirm. The system starts to delete all password users;



Once finishing the operations, please try to use the deleted user for unlocking to confirm the operation is successful.

8 Delete All Normal Users

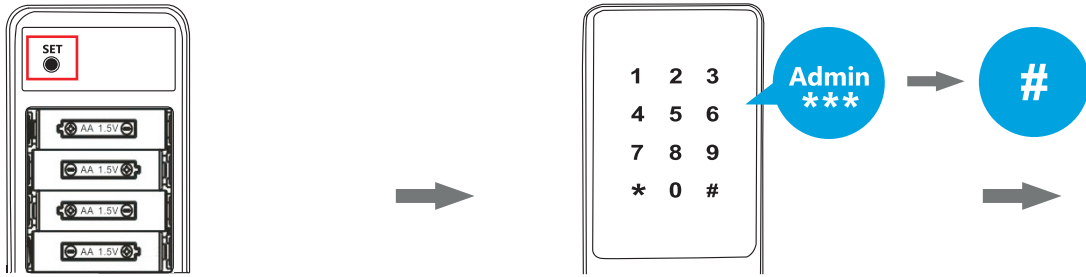

a Take out the battery case cover, and then press "Set" button on the battery case;

b Input the Admin password, and then press "#" to confirm;

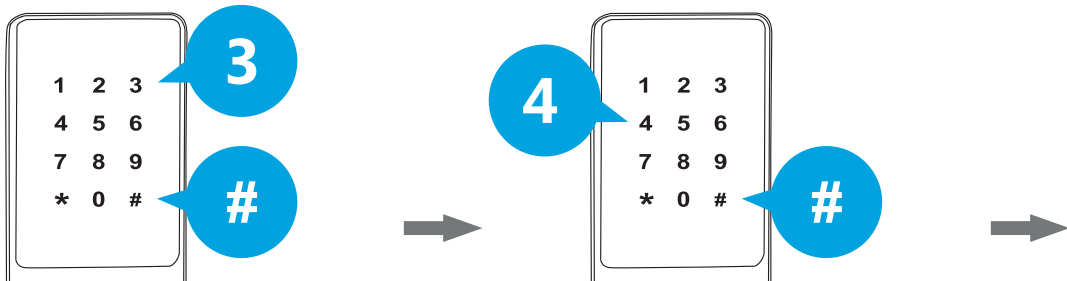

c Input "3", and then press "#" to confirm;

d Input "4", and then press "#" to confirm;

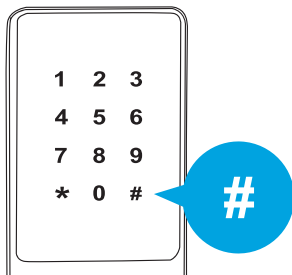

e Input "#" again to confirm. The system starts to delete all normal users;



Once finishing the operations, please try to use the deleted user for unlocking to confirm the operation is successful.

9 Double Unlocking

For a higher level security, you can activate the "Double Unlocking" mode, which needs input 2 registered users for unlocking every time.

*Enable

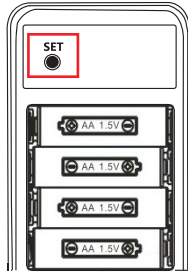

- a Take out the battery case cover, and then press "Set" button on the battery case;

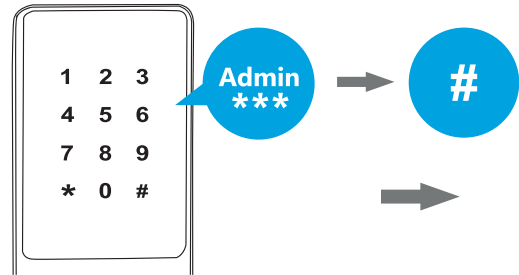

- b Input the Admin password, and then press "#" to confirm;

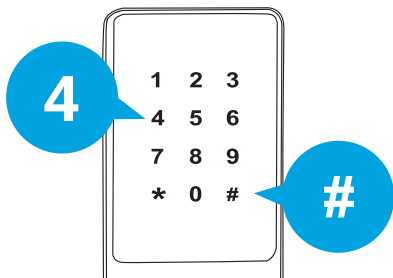

- c Input "4", and then press "#" to confirm;

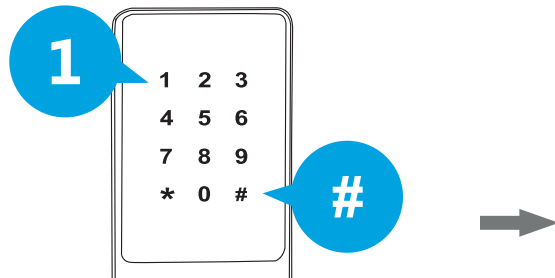

- d Input "1", and then press "#" to confirm;

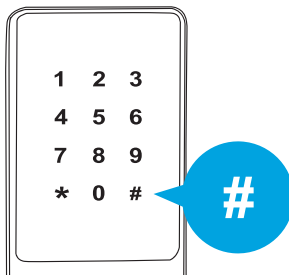

- e Input "#" again to confirm and the "double unlocking mode" is activated.



Once the lock is under double unlocking mode, you need to input those 2 registered users within 5 seconds. Otherwise the lock will be turned off.



When the first user is inputted, the lock keeps locked until you input the second registered user, and then you can press down the handle for unlocking.



If there are only one kind of users registered in the lock (only password users or only RF card users), the lock only can be unlocked by admin password. Because the lock requests 2 different kinds of users for unlocking in "Double Unlocking" mode. It is suggested to register both kinds of users in the lock.

*Disable

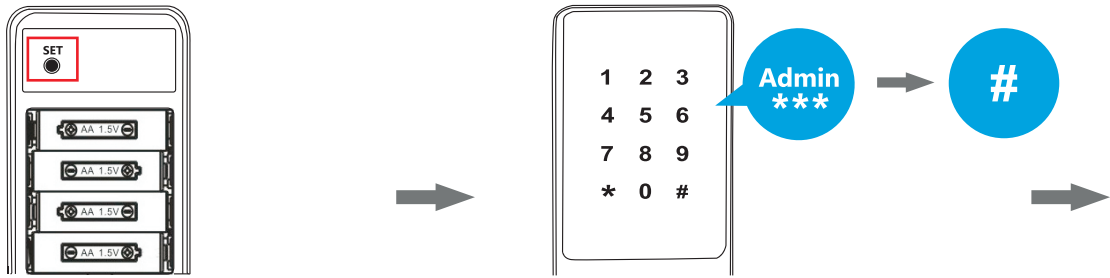

a Take out the battery case cover, and then press "Set" button on the battery case;

b Input the Admin password, and then press "#" to confirm;

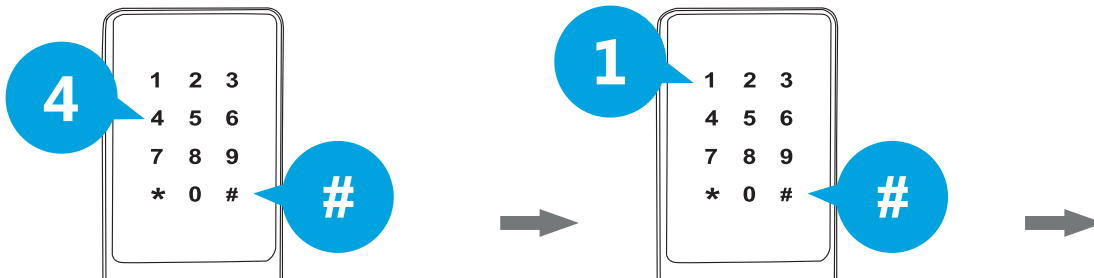

c Input "4", and then press "#" to confirm;

d Input "1", and then press "#" to confirm;

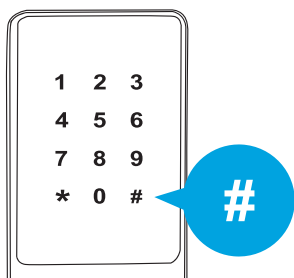

e Input "#" again to confirm and the "double unlocking mode" is disabled.

10 Temporary Password User

For the guest and housekeeper who needs to access, you can set up the "Temporary Password User" for them, once they use the password for unlocking, that password will be delete automatically. (Only one time use)

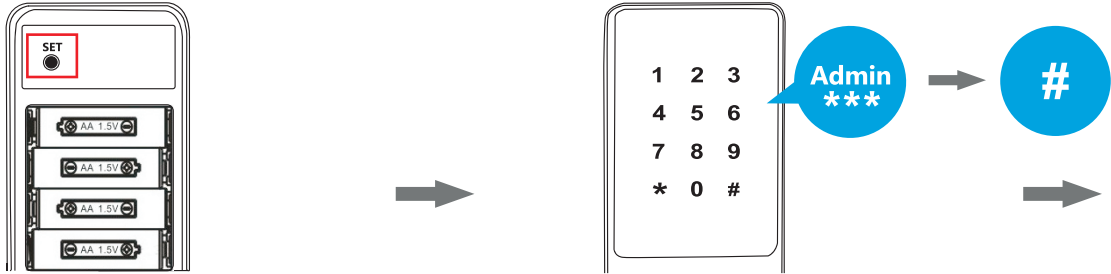

a Take out the battery case cover, and then press the "Set" button on the battery case;

b Input the Admin password, and then press "#" to confirm;

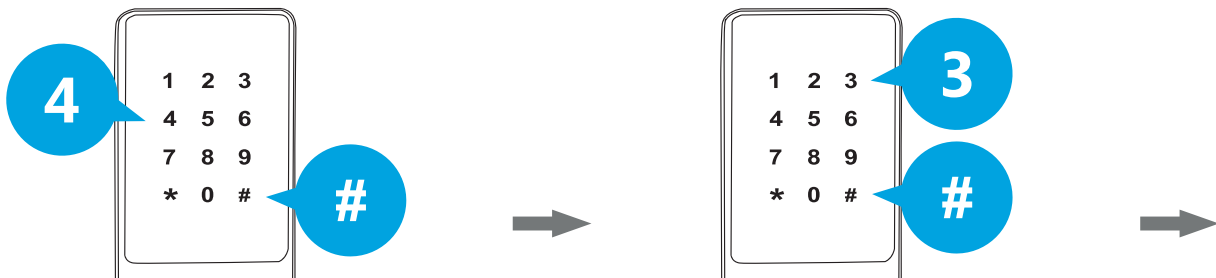

c Input "4", and then press "#" to confirm;

d Input "3", and then press "#" to confirm;

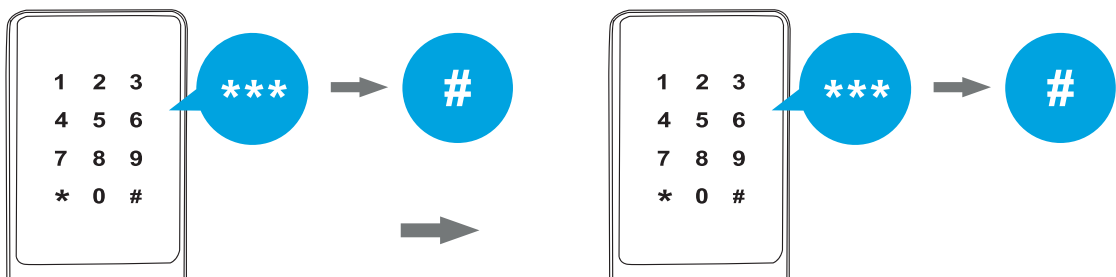

e Input the password and then press "#" to confirm; (the password is 4 to 6 digits)

f Input the password again, and then press "#" to confirm; (the password is 4 to 6 digits)



After set up the temporary password user, that password is available until use.

11 User Number Management

In order to manage the registered users better, you can activate the user ID management. Once the management is activated, you have to input ID numbers when registering new users. **Factory default is disabled.**

*Enable

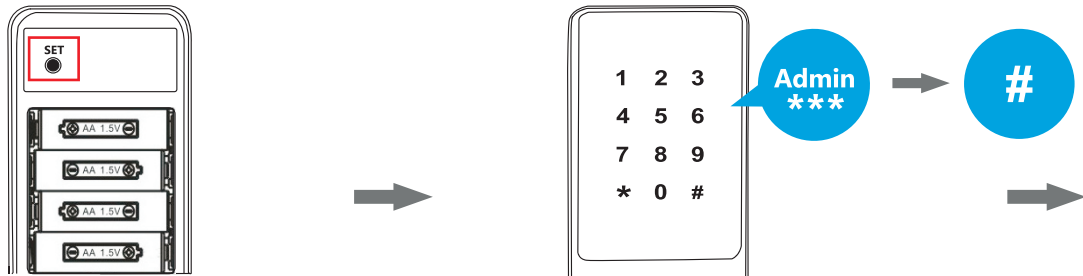

a Take out the battery case cover, and then press the "Set" button on the battery case;

b Input the Admin password, and then press "#" to confirm;

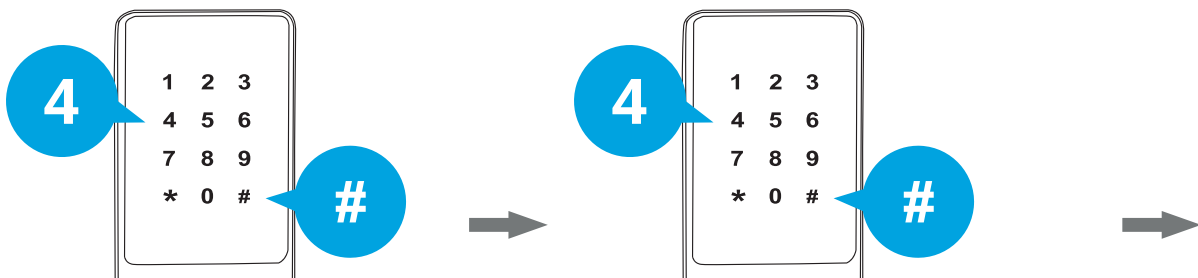

c Input "4", and then press "#" to confirm;

d Input "4", and then press "#" to confirm;

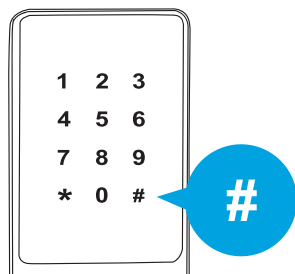

e Input "#" again to confirm and the user management is activated.

*Disable

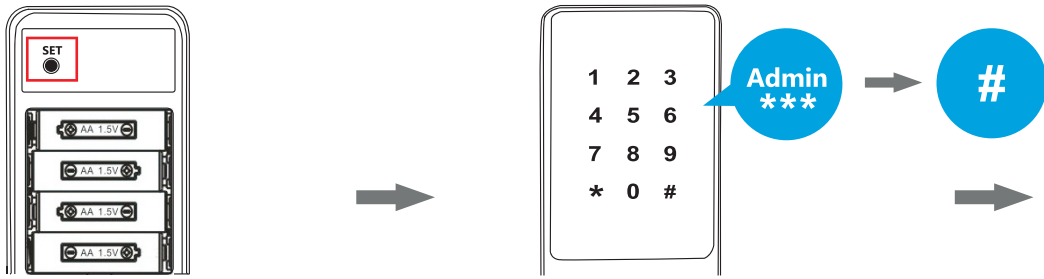

a Take out the battery case cover, and then press "Set" button on the battery case;

b Input the Admin password, and then press "#" to confirm;

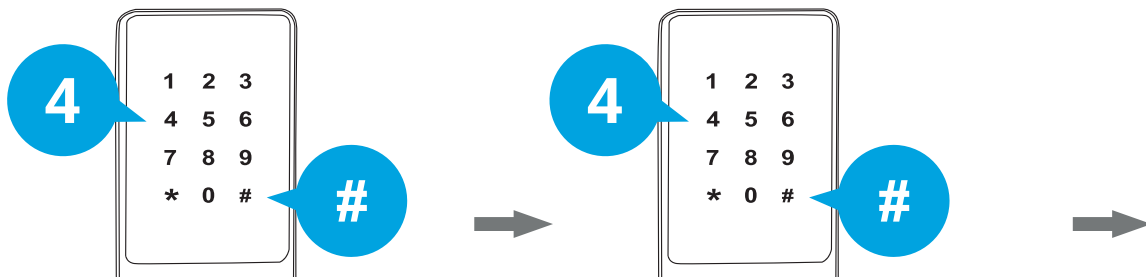

c Input "4", and then press "#" to confirm;

d Input "4", and then press "#" to confirm;

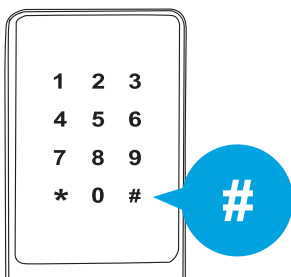

e Input "#" again to confirm and the user management is disabled.

12 Passage Mode

When the lock is requested for unlocking frequently, you can activate the passage mode and let the people unlocking without identifications.

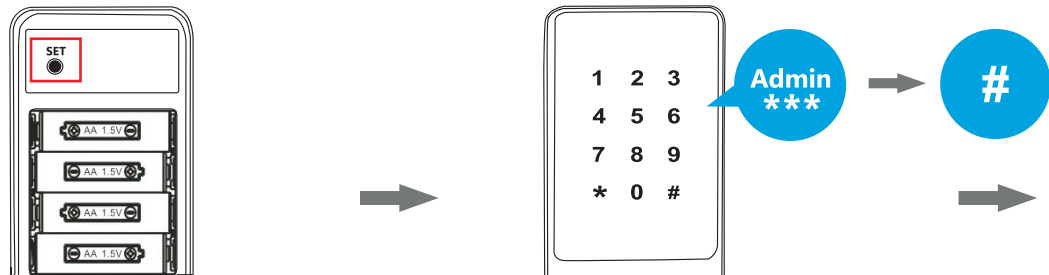

a Take out the battery case cover, and then press "Set" button on the battery case;

b Input the Admin password, and then press "#" to confirm;

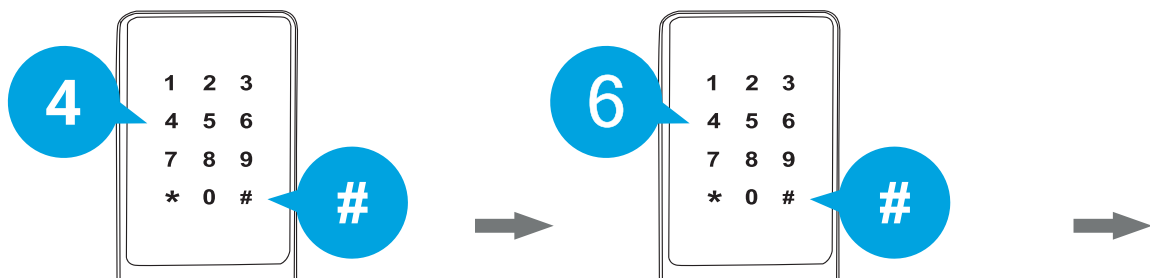

c Input "4", and then press "#" to confirm;

d Input "6", and then press "#" to confirm;

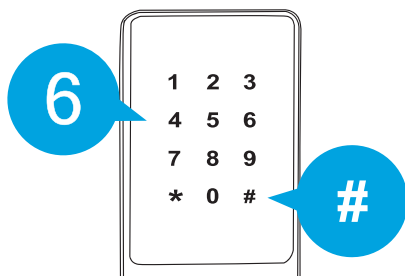

e Input "6", and then press "#" again to remove Passage Mode

13 Restore The Lock to Factory State

When the lock has some problems, you can try to restore the lock to solve.

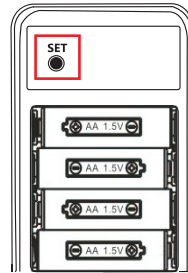
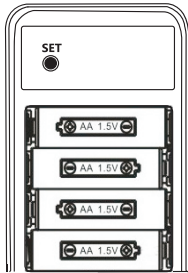

a Take out the batteries from the battery case;

b Press and hold the "Set" button on the battery case;

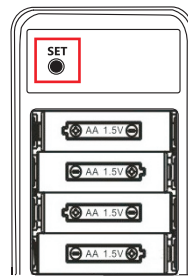
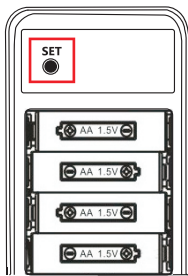

c Install the batteries into the case, keep holding the "Set" button;

d Keep holding the "Set" button until you hear the speaker says "initialization successfully"



After restore the lock, the admin password will be restore to factory default "123-456", please change the master password before use.



All users will be deleted after lock restored.